

# ED 11-K

Einströmdüsen/ fan inlet cones



**punker GmbH**  
Niewark 1  
24340 Eckernförde  
Germany

**punker LLC**  
914 25th Street SE  
Hickory, NC 28602  
USA

Fon: +49.4351.472.0    Fon: +1.828.322.1951  
Fax: +49.4351.472.740    Fax: +1.828.328.1336  
info@punker.com ▶ www.punker.com

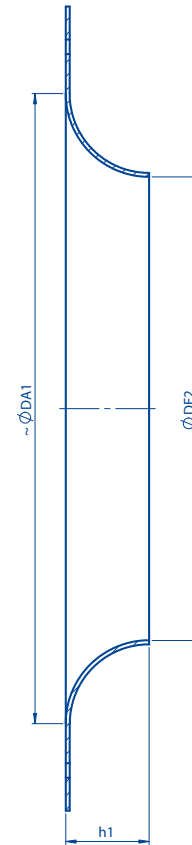
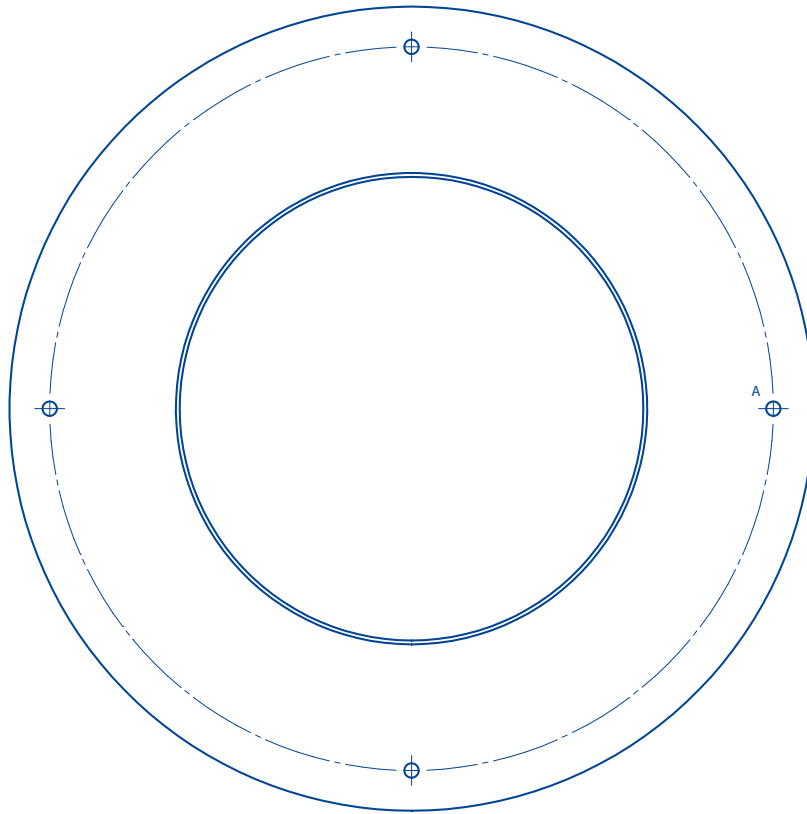

Bestellbeispiel für Einströmdüsen/ order example for fan inlet cones: **ED 11-K / 400**

Type ED 11-K	250	280	315	355	400	450	500	560	630	710	800	900	1000	
Rad/ wheel	R 62../ R 63 ..	250	280	315	355	400	450	500	560	630	710	800	900	1000
~ø DA1		225,7	254,4	286,2	322,6	363,5	408,9	454,2	509,6	574,6	646,0	729,8	820,6	912,7
		8,89	10,02	11,27	12,70	14,31	16,10	17,88	20,06	22,62	25,43	28,73	32,31	35,93
ø DE2		168,7	189,6	213,2	239,6	271,5	304,9	338,2	379,6	428,6	481,0	542,8	610,6	678,7
		6,64	7,46	8,39	9,43	10,69	12,00	13,31	14,94	16,87	18,94	21,37	24,04	26,72
h1		30,0	34,0	38,0	43,0	48,0	54,0	60,0	67,0	75,0	85,0	96,0	108,0	120,0
		1,18	1,34	1,50	1,69	1,89	2,13	2,36	2,64	2,95	3,35	3,78	4,25	4,72

Optional lieferbar/ optionally available:  
Mit individuellem Lochkreis (siehe "A")/ with individual hole circle (see "A")

